

| REVISIONS | |
|-----------|--|
| A | Design development revision. Revision to structural grid wall below stair and 1FL increased by 170mm to engineers' comments. |
| B | Thermal insulation added and overall thickness increased to GF office/warehouse dividing walls meet Part L requirement, 1F walls adjusted to suit. |
| C | Lower locations added. General drawing development |

Note:
Walls between office and warehouse to achieve a minimum U-value of 0.27 W/m²K and FR 60mins. Doors between office and warehouse to achieve a minimum U-value of 2.2 W/m²K and FR 60mins.

Note:
All compartmentation walls between each units to achieve FR 60mins.

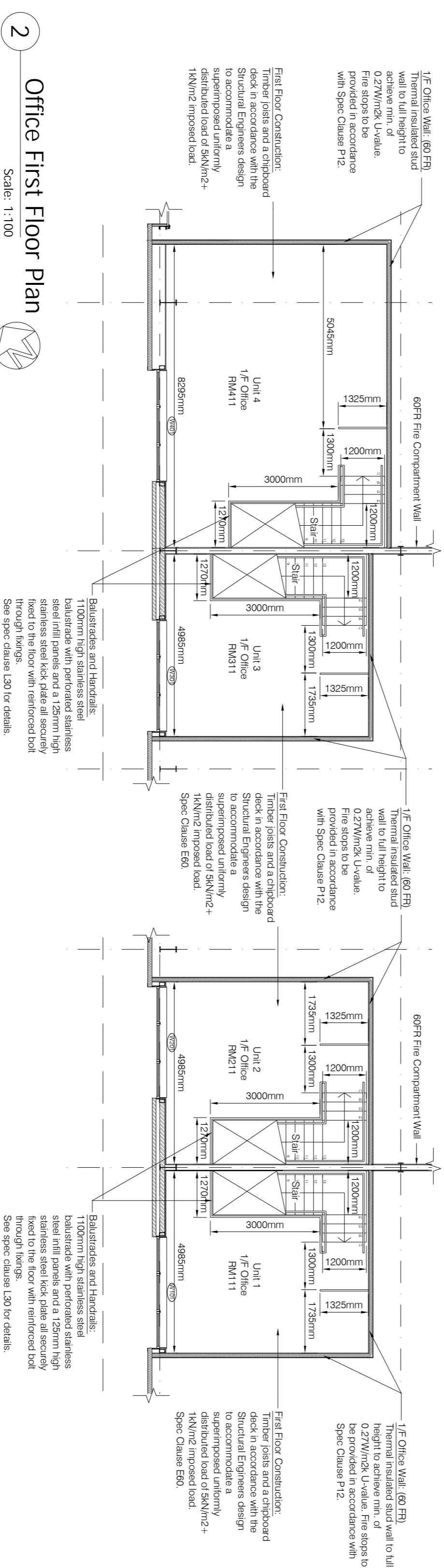
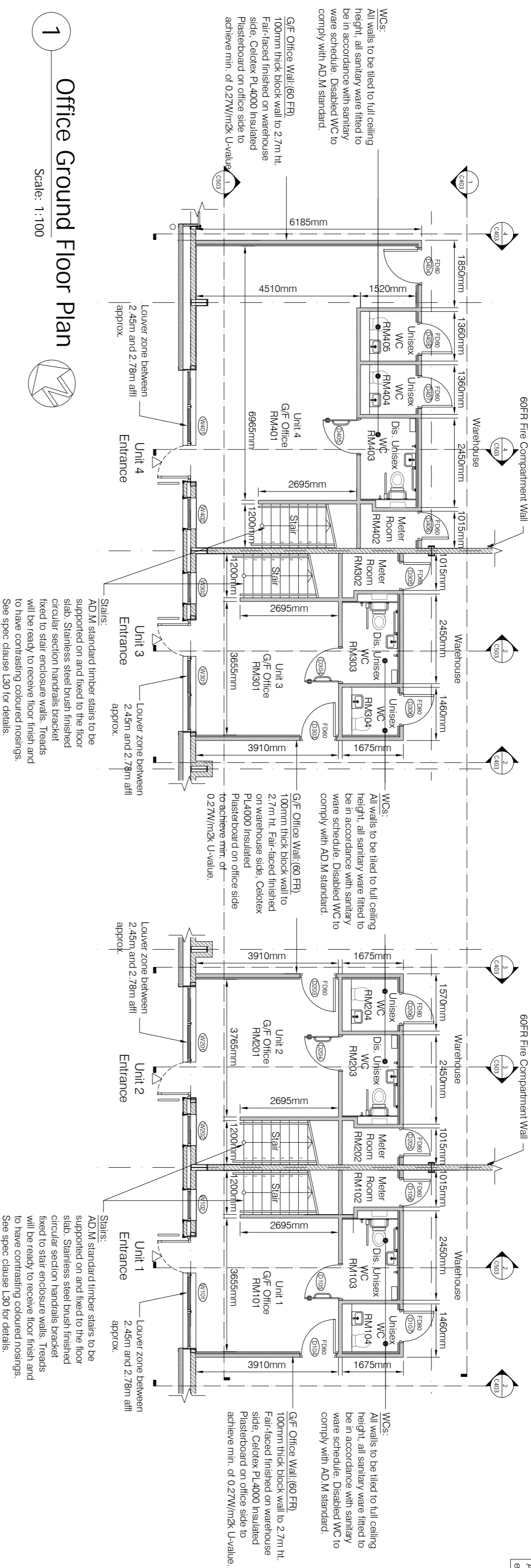

For Tender

| | | | | | |
|---|--|--|-----------------------|--------------------------|---|
| <p>THE CLIENT: PRINCES BUSINESS CENTRE LIMITED 19 SUMMERLEYS ROAD, WINDYBUSH, DURBAN 4013 TELEPHONE: 031 2588617 FAX: 031 2588699 EMAIL: CLIENT@PBC.CO.ZA</p> | <p>the D.C.M. partnership</p> | <p>PROJECT: Princes Business Centre Summerleys Road</p> | <p>DATE: 19/10/17</p> | <p>SCALE: 1:100 @ A2</p> | <p>ISSUED FOR APPROVAL: JSS</p> <p>DRAWN: JSS</p> <p>CHECKED: JSS</p> |
|---|--|--|-----------------------|--------------------------|---|