

Landscape Notes:

Objectives are:

- to help integrate the development into the local landscape by continuing themes found on the adjacent Ercol site,
- to provide appropriate planting in association with site entrance and parking areas,
- to provide screen planting adjacent to the railway boundary (within the constraints posed by Network Rail planting recommendations),
- to take opportunities to enhance local biodiversity.

Tree Planting:

Plane trees are used at the site entrance to provide a tie-in with those already used as a feature on the adjacent Ercol site.

Hornbeam is also being proposed as a native species which does well on the chalky soils of the area. It forms an upright well-shaped tree.

To accord with NHBC advice on tree planting and foundation depths no tree planting is shown within 5m of the end of Unit 1. As large trees both Plane and Hornbeam are not advised to be planted within 10m of the buildings so instead it is proposed to plant a group of 3 no. Ornamental Pear (Pyrus 'Chanticleer') at this end of the site entrance area.

This tree has an upright form which will echo that of the Hornbeam and has white flowers in Spring and offers good Autumn colour.

Hedging:

Car parking area near the site entrance are defined by Beech hedging, planted as 1.2m high 'ready hedge' and maintained at between 1.2 and 1.5m.

Shrub Planting:

The line of trees to the railway side of the site entrance is proposed to be under-planted with select cultivars of Dogwood, whose stems give good colour in winter. Once established the plants will be coppiced on a rotation to ensure plenty of fresh stems each season and to help plant longevity.

Elsewhere there will be evergreen shrub planting, both ground cover and taller shrub species as appropriate, adjacent to car parking areas.

On the west side of the site entrance hard-paved access is required to the sub-station building to allow periodic installation or removal of equipment.

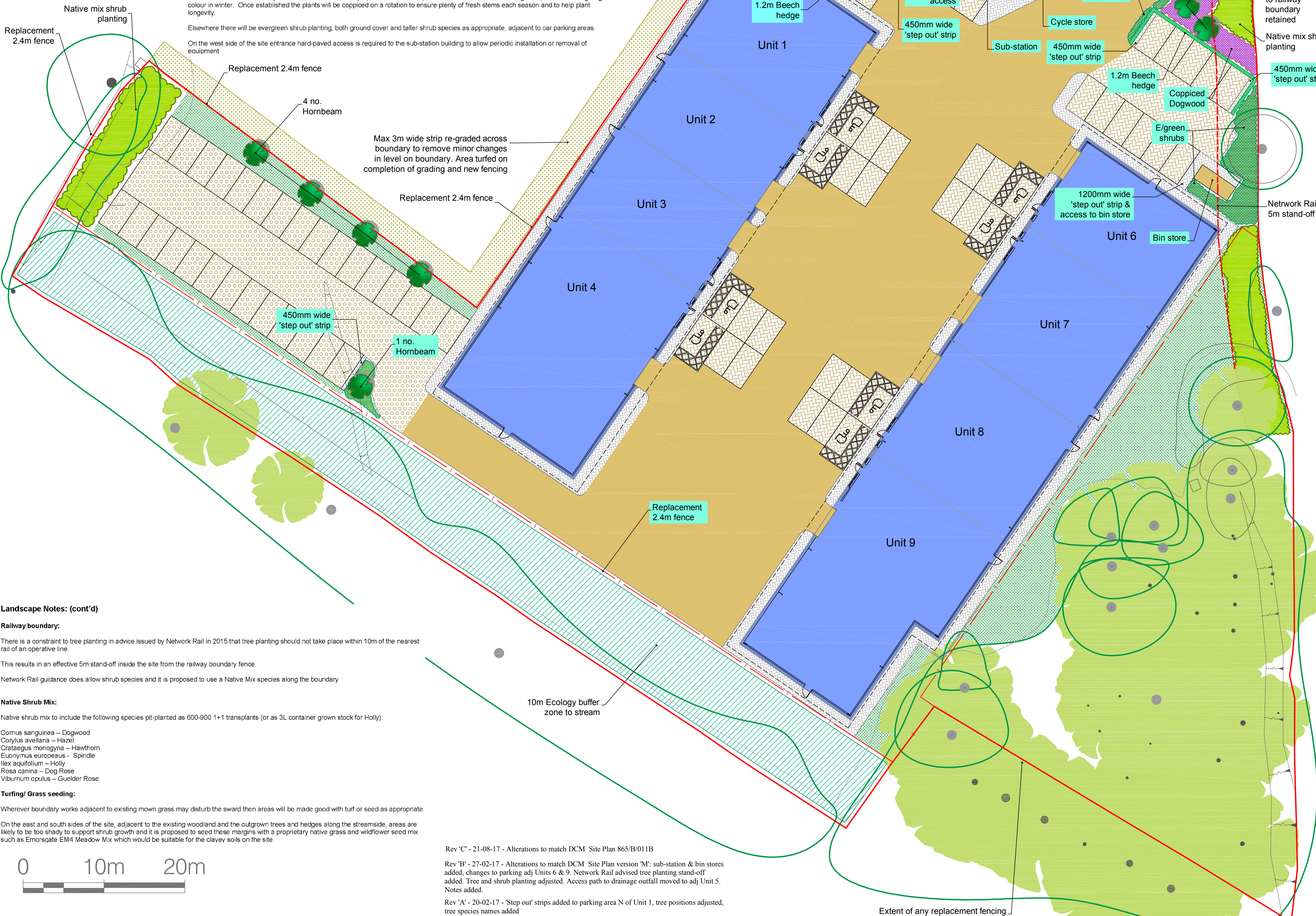

Key:

- Existing tree, tree group or out-grown hedge retained
- Existing tree retained
- Proposed EHS tree, 14-16 cm girth, 4.0-4.5m tall
- Proposed feathered standard tree, 8-10 cm girth, 1.8-2.1m tall
- Native mix tree & shrub planting - 1+1 transplants at av 1r centres
- Deciduous shrub planting (e.g. Dogwood) - 60-90cm 3L CG (2 no. per sq.m.) coppiced on 3yr rotation once established
- Evergreen groundcover planting - 30-40cm 3L CG (3-5 no. per sq.m.)
- 1.5m tall 'Ready Hedge', nominally 100 x 40 cm units, planted in prepared trench
- Max 3m wide strip minor grading across boundary before installing new boundary fence. Area turfed on completion of grading and fencing work
- Area overseeded and/or turfed following completion of fencing work
- Areas sown with low maintenance grass & wildflower mix
- Porous block paved parking bays with thermoplastic paint markings
- 1.5m wide porous block paved path to surrounding of buildings. Vehicle circulation areas in concrete
- Parking and circulation area in 'grasscrete' construction.
- 10m Ecology buffer zone to stream.
- Network Rail advised 10m stand-off from nearest rail. No tree planting within zone (approx 5m from railway boundary fence)

Rev 'D' - 24-08-17 - Alterations to match BCAL Proposed External Finishes Dwg 5619-23 B

Do not scale from drawing - if in doubt ask

Ed Sharkey Associates

Landscape Architects and Environmental Consultants

49 Meadow Rise, Barton under Needwood, Burton upon Trent, Staffs, DE13 8DT
Tel: 01283 713124 Mobile: 07973 151820 E-mail: edsharkeyassociates@btinternet.com

Project
Princes Business Centre
Summerleys Road Princes Risborough
Bucks, HP27 9LE

Drawing Title: **Planning Issue**
Landscape Proposals

Drawing No.	Rev	Scale	Date	Drawn	Chk
16-07/01	D	1:250 @ A1	Feb '17	ES	

Computer File No. C:\2016\16-07\ESA\ESA-Landscape-01c.dwg

Landscape Notes: (cont'd)

Railway boundary:
There is a constraint to tree planting in advice issued by Network Rail in 2015 that tree planting should not take place within 10m of the nearest rail of an operative line.
This results in an effective 5m stand-off inside the site from the railway boundary fence.
Network Rail guidance does allow shrub species and it is proposed to use a Native Mix species along the boundary

Native Shrub Mix:
Native shrub mix to include the following species pit-planted as 600-900 1+1 transplants (or as 3L container grown stock for Holly):
Cornus sanguinea - Dogwood
Corylus avellana - Hazel
Crataegus monogyna - Hawthorn
Euonymus europaeus - Spindle
Ilex aquifolium - Holly
Rosa canina - Dog Rose
Viburnum opulus - Guelder Rose

Turfing/ Grass seeding:
Wherever boundary works adjacent to existing mown grass may disturb the sward then areas will be made good with turf or seed as appropriate.

On the east and south sides of the site, adjacent to the existing woodland and the outgrown trees and hedges along the streamside, areas are likely to be too shady to support shrub growth and it is proposed to seed these margins with a proprietary native grass and wildflower seed mix such as Emoregate EM4 Meadow Mix which would be suitable for the clayey soils on the site.

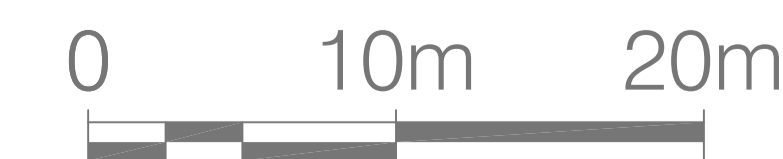

Rev 'C' - 21-08-17 - Alterations to match DCM Site Plan 865/B/011B

Rev 'B' - 27-02-17 - Alterations to match DCM Site Plan version 'M': sub-station & bin stores added, changes to parking adj Units 6 & 9. Network Rail advised tree planting stand-off added. Tree and shrub planting adjusted. Access path to drainage outfall moved to adj Unit 5. Notes added.

Rev 'A' - 20-02-17 - 'Step out' strips added to parking area N of Unit 1, tree positions adjusted, tree species names added

Extent of any replacement fencing in wooded area to be determined